

*Desoutter*



**Industrial**Tools



**EABS**

THE one hand nutrunner

BOOST YOUR  
**PRODUCTIVITY**

BOOST YOUR  
**FLEXIBILITY**

BOOST YOUR  
**UPTIME**

**More Than Productivity**



**EABS**

# THE ONE HAND NUTRUNNER

COMPACTNESS



TRANSDUCER TECHNOLOGY



ERGONOMIC HANDLE



EASY LINE REBALANCING WITH  
WIRELESS PAIRING [RFID]



BATTERY LOAD  
INDICATOR



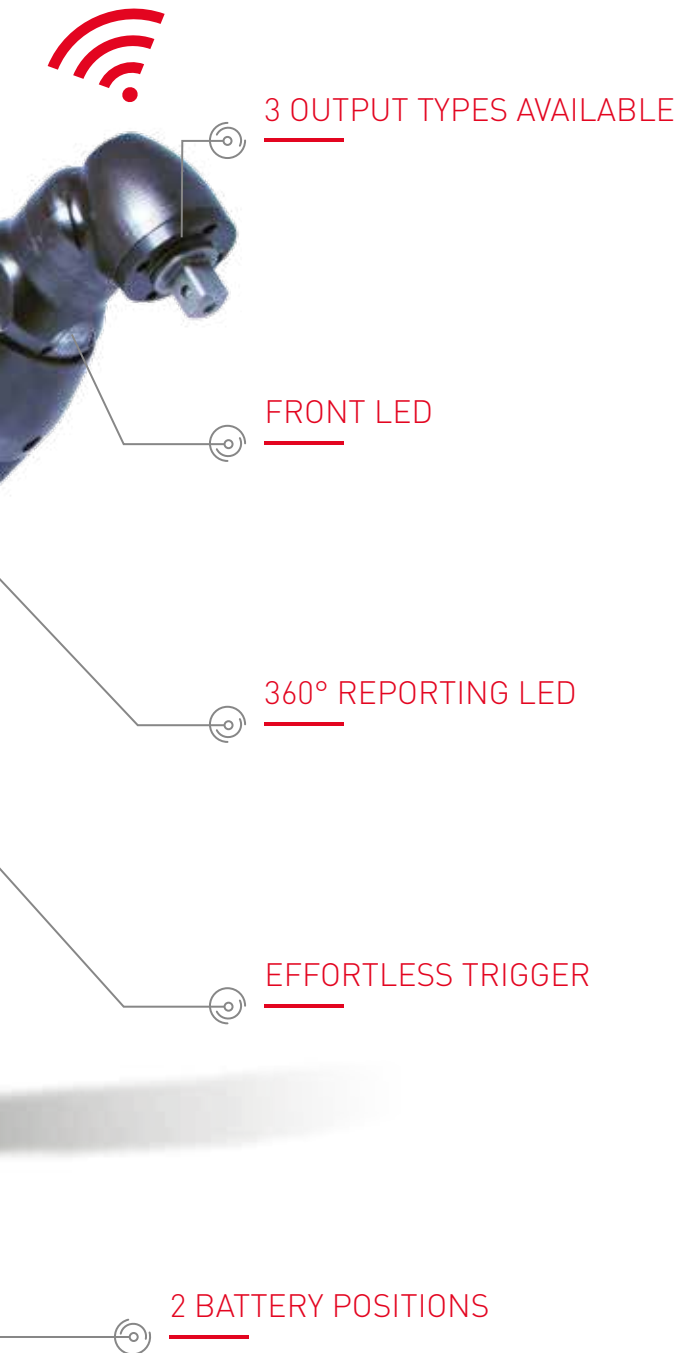

## BOOST YOUR FLEXIBILITY

- ▶ COMPACT & LIGHT WEIGHT FOR EASY HANDLING
- ▶ DIRECT LED FEED-BACK WITH OUR 360° VISIBILITY APPROACH
- ▶ 3 OUTPUT DRIVE TYPES (HEX1/4, SQ1/4, SQ 3/8)
- ▶ 2 WORKING MODES: WIRELESS COMMUNICATION MODE AND DISCONNECTED MODE

## BOOST YOUR UPTIME

- ▶ FAST TOOL'S REBALANCING WITH WIRELESS EASY PAIRING
- ▶ DUST & OIL PROOF TRIGGER
- ▶ LONG LIFE BATTERIES

## BOOST YOUR PRODUCTIVITY

- ▶ HIGH SPEED TOOL WITH 18V BATTERY
- ▶ ONE HAND FOR THE TOOL, ONE HAND TO BOOST PRODUCTIVITY
- ▶ INDUSTRIAL GRADE WIRELESS COMMUNICATION FOR THE MOST DEMANDING ENVIRONMENTS

## COMPACTNESS

EABS IS A CONCENTRATION OF ADVANCED TECHNOLOGY which allows to get a compactness never reached up to now with transducerized battery tools.

With a length at 30 cm, EABS can be used with only one hand. Consequently, one hand is released and could be used either to boost productivity or to improve operator's balance during tightening.



## HIGH SPEED BATTERY TOOLS WITH 18V BATTERY



EABS IS A PERFECT BALANCE BETWEEN ERGONOMICS AND PRODUCTIVITY

EABS can reach really high speed to boost your productivity even with an 18V battery. Indeed, with an EABS 8 model and an EABS 12 model, free speed values are higher than 1000 rpm while preserving ergonomy with a total weight less than 1.5 kg.

## LED REPORTING

### FRONT LED

Front LED is really close to the tightening part for a perfect lighting.



### REPORTING LED

The combination of front LED with the reporting LED's on the side ensure the feed-back to the operator is always visible. With no extra effort to view.



## TOOL'S REBALANCING



### EASY WIRELESS PAIRING

The EABS tool has an embedded RFID chip for fast and efficient pairing with the CONNECT. Error proofing the process and eliminating any potential wireless setting mistakes.

With easy wireless pairing, tool is paired in less than **10 seconds**.

## WORKING COMMUNICATION MODES

### WIRELESS COMMUNICATION

EABS is delivered in a standard wireless communication mode. Enabling the communication of fastening data to the CONNECT or CVi3 Vision.



### DISCONNECTED MODE

Using the disconnected mode, it is possible to disable the WIFI module to use as a standalone tool.

### TIGHTENING

Results in memory



### DOWNLOADING

Download result to CVi Monitor/Analyzer software.

## TIGHTENING PROCESS OPTIMIZATION

- NETWORK COMMUNICATION : standard fieldbus & advanced customer protocols
- TIGHTENING STRATEGY : combine flexible steps with different control and different monitoring
- DIRECT VISUALISATION AND ACCESS : simple configuration and results on the controller screen and on a remote HMI
- ASSEMBLY PROCESS : control a complete operation with several fastenings and logical requirements (scans, I/O, ...)



## FULL TRACEABILITY

- FULL DATA TRACEABILITY
- ALL DATA stored thanks to real time collection and storage
- ACCESSIBLE BY EVERYONE for data viewing with just a web browser with secured access
- FAST PROCESSING FOR THE RESULTS, curves and statistics report with a click

## ERROR PROOFING

Thanks to dedicated error proofing accessories on a bus communication, **the process is 100 % reliable and under control**. Possibility to extend your automation control with the **CVI Logix features** to have a complete stand alone working station.





## EABS SERIES



PIC	MODEL	PART NUMBER	OUTPUT DRIVE	TORQUE						MAX. ROTATIONAL SPEED	WEIGHT WITHOUT BATTERY		LENGTH WITHOUT BATTERY		VOLTAGE
				MIN.	RECOMMENDED	MAX.	MIN.	RECOMMENDED	MAX.		Kg	lb	mm	.in	
A	EABS8-1500-4Q	615 166 088 0	HEX. 1/4	1.5	7	8	1.10	5.16	5.90	1500	1.0	2.20	297	11.69	18/36
B	EABS8-1500-4S	615 166 087 0	SQ 1/4	1.5	7	8	1.10	5.16	5.90	1500	1.0	2.20	297	11.69	18/36
A	EABS12-1100-4Q	615 166 091 0	HEX. 1/4	4	10	12	2.95	7.37	8.85	1100	1.0	2.20	297	11.69	18/36
B	EABS12-1100-4S	615 166 089 0	SQ 1/4	4	10	12	2.95	7.37	8.85	1100	1.0	2.20	297	11.69	18/36
B	EABS12-1100-10S	615 166 090 0	SQ 3/8	4	10	12	2.95	7.37	8.85	1100	1.0	2.20	297	11.69	18/36
A	EABS17-800-4Q	615 166 094 0	HEX. 1/4	5	14	17	3.68	10.32	12.53	800	1.0	2.20	297	11.69	18/36
B	EABS17-800-4S	615 166 092 0	SQ 1/4	5	14	17	3.68	10.32	12.53	800	1.0	2.20	297	11.69	18/36
B	EABS17-800-10S	615 166 093 0	SQ 3/8	5	14	17	3.68	10.32	12.53	800	1.0	2.20	297	11.69	18/36
C	EABS24-500-4Q	615 166 096 0	HEX. 1/4	10	22	24	7.37	16.22	17.70	520	1.3	2.87	335	13.19	18/36
D	EABS24-500-10S	615 166 095 0	SQ 3/8	10	22	24	7.37	16.22	17.70	520	1.3	2.87	335	13.19	18/36

## ACCESSORIES



### ACCESSORIES INCLUDED

ITEM	PART NUMBER
• Protective cover EABS 8 - EABS 12 - EABS 17	615 813 250 0
• Protective cover EABS 24	615 813 251 0

### OPTIONAL ACCESSORIES

ITEM	PART NUMBER
<b>BATTERY TYPE</b>	
1 Li-ion battery pack 18V 2.5 Ah - 0.46 kg (1,01lb)	615 813 266 0
2 Li-ion battery pack 36V 2.5 Ah - 0.77 kg (1,70lb)	615 813 267 0

### CHARGER

3	Charger Universal 18 / 36V	615 813 270 0
---	----------------------------	---------------

### PROTECTIVE COVERS - TOOLS

4	For angle head EABS 8 - 12 and 17	615 813 250 0
4	For angle head EABS 24	615 813 251 0

### PROTECTIVE COVERS - BATTERY

5	For battery 18V - 2.1 Ah - Clear	615 396 871 0
5	For battery 18V - 2.1 Ah - Black	615 211 041 0
5	For battery 18V - 2.1 Ah - Blue	615 211 042 0
5	For battery 18V - 2.1 Ah - Red	615 211 043 0
5	For battery 18V - 2.1 Ah - Grey	615 211 044 0
5	For battery 36V - 2.1 Ah - Clear	615 396 872 0
5	For battery 36V - 2.1 Ah - Black	615 211 046 0
5	For battery 36V - 2.1 Ah - Blue	615 211 047 0
5	For battery 36V - 2.1 Ah - Red	615 211 048 0
5	For battery 36V - 2.1 Ah - Grey	615 211 049 0

### MISCELLANEOUS

6	eDOCK	615 811 976 0
---	-------	---------------

### DESOUTTER TOOL HOLSTER

7	DTH TWIN (single) without rail	615 811 411 0
8	DTH Battery (single) without rail	615 813 385 0

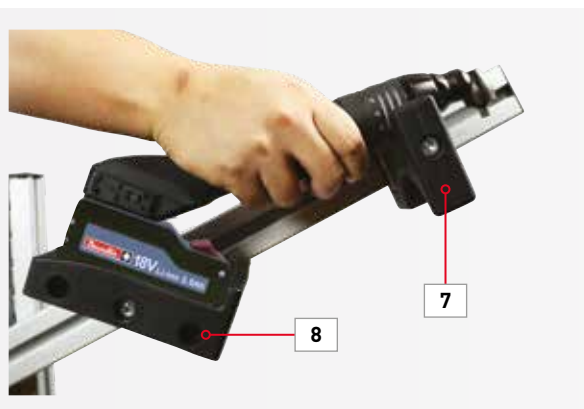

### DTH BATTERY

- Good tool grip
- Battery holder 18V or 36V
- Fit with the 2 battery positions



# THE ONE HAND NUTRUNNER



**BOOST YOUR  
PRODUCTIVITY**

**BOOST YOUR  
FLEXIBILITY**

**BOOST YOUR  
UPTIME**

# EABS SERVICE SOLUTIONS

## COMMITTED TO OUR CUSTOMERS SUCCESS

MAINTENANCE SOLUTIONS  
REDUCE BREAKDOWNS AND  
EXTEND TOOL LIFE TO BOOST  
COST EFFICIENCY, UPTIME  
AND PRODUCTIVITY

### Basic Care

A flexible fixed price preventive maintenance program with calibration that includes wear parts and labour.

### Smart Care

A fixed price preventive maintenance plan with calibration and repairs included.\*

The maintenance is optimised according to the tool usage.

All wear parts are replaced at the right time.

### Peace of mind

Onsite maintenance and production support that includes:

An optimised preventive maintenance plan with calibration and repairs included.\*

Plus technical support for trouble shooting, optimisation and operator coaching to maximise the efficiency of your tools.

\* Except in case of misuse or abuse



SMART START  
HIGH PERFORMANCE, RIGHT FROM THE START!

A fast, high quality installation with no delays that ensures tool accuracy and optimum set-up.



## PRODUCTION SUPPORT ON-SITE SUPPORT TO HELP BOOST UPTIME AND PRODUCTIVITY

### On-site technicians

Our certified technicians are on hand to quickly solve any on-site issues detected or identify process improvement opportunities.

### Certification Training

Develop your technicians' knowledge on troubleshooting and assembly technics. Improve the interaction with Desoutter for efficient remote support.

## BOOST YOUR UPTIME

- ▶ Preventive Maintenance significantly reduces breakdowns and therefore production stops. Uptime is improved.
- ▶ Our experienced on-site technicians know your applications and are on hand to support your team. This allows early detection and resolution of problems, Your uptime is further improved.

## BOOST YOUR PRODUCTIVITY

- ▶ Desoutter on-site technicians will coach and support your teams on how to get the best from your equipment. This helps to reduce errors and rework, boosting productivity and quality.
- ▶ Our on-site technicians will help your team to identify and implement process improvements to help you further boost productivity.

## BOOST YOUR MAINTENANCE COST EFFICIENCY

- ▶ Preventive Maintenance decreases breakdowns and extends tool life. This significantly reduces repair and administration costs.

## BOOST YOUR FLEXIBILITY

- ▶ All our service solutions can be tailored to your exact needs to ensure maximum flexibility in your production locally or worldwide.

# More Than Productivity